

SHIELDED SURFACE-MOUNT POWER INDUCTORS

SPI0804S SERIES



FEATURES:

- Current up to 5A
- Very Small Foot Print
- Flat-top for Pick & Place

COMMON APPLICATIONS:

- Ideal for Palm-Top and Laptop DC-DC Converters
- PDA's Flash Memory
- Step-up, Step-down Converters

ELECTRICAL CHARACTERISTICS :

Part Number SPI0802S-	L (μ H) $\pm 20\%$	DCR (Ω) Max	IDC (A) Max
1R0	1.0	0.021	5.0
1R5	1.5	0.022	4.5
2R2	2.2	0.032	3.8
3R3	3.3	0.039	3.3
4R7	4.7	0.054	2.7
6R8	6.8	0.075	2.2
100	10	0.101	2.0
150	15	0.150	1.5
220	22	0.207	1.3
330	33	0.334	1.1
470	47	0.472	0.80

- Testing: (Equivalent acceptable)
Inductance: HP4285A
RDC: QuadTech 1880 Milliohm meter
-Q- HP4342A - SRF-HP4191A
- IDC Max: Determined when superimposed DC current is decreased 10% against its initial value
- Operating Temperature: -40°C to $+85^{\circ}\text{C}$
- Storage Temperature: -40°C to $+105^{\circ}\text{C}$
- Solder methods: Vapor Phase, Infrared Reflow
- Resistance to soldering heat: 260°C for 10 seconds
- Solvent resistance: Conforms to MIL-STD-202E
- Marking: Inductance & Tolerance

PHYSICAL CHARACTERISTICS

DIMENSION:(mm)

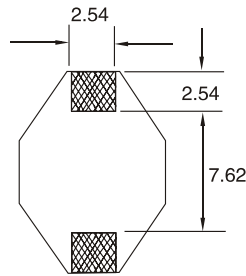
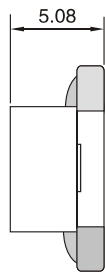
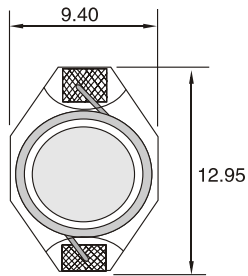

PAD LAYOUT

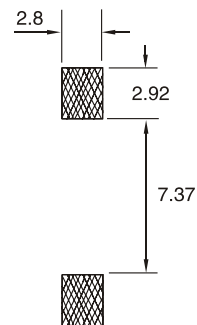

Notel: All specification subject to change without noticed.